

APPENDIX C
PROJECT LAYOUT AND DRAWINGS

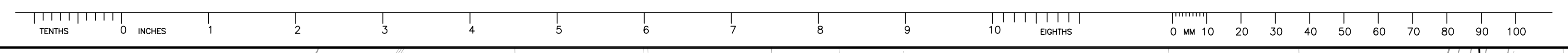

PROPERTY	AC POWER CAPACITY	
	1 MW	0.5 MW
1	3	-
2/1	1	-
3	5	0.5
4	4	0.5
5	-	-
6A	3	-
6B	-	-
7/9/10	3	0.5
11A	2	0.5
11B	-	-
12	6	0.5
13	-	-
14A	21	-
14B	8	-
14C	4	-
15	-	-
16	-	-
17	-	-
18	-	-
19	5	-
20	1	-
19/20	9	-
21	5	0.5
22	6	0.5
23	3	-
24	3	-
SUBTOTAL	90	3.5
TOTAL	93.5	

CIRCUIT No	CCT. #1	CCT. #2	CCT. #3	CCT. #4
	1	P2/1-U1	P6A-U1	P7/9/10-U1
2	P1-U1	P6A-U2	P7/9/10-U2	P21-U2
3	P1-U2	P6A-U3	P7/9/10-U3	P21-U3
4	P1-U3	P14A-U1	P7/9/10-U4	P21-U4
5	P3-U1	P14A-U2	P11A-U1	P21-U5
6	P3-U2	P14A-U3	P11A-U2	P21-U6
7	P3-U3	P14A-U4	P11A-U3	P21-U7
8	P3-U4	P14A-U5	P14B-U1	P21-U8
9	P3-U5	P14A-U6	P14B-U2	P21-U9
10	P3-U6	P14A-U7	P14B-U3	P22-U1
11	P4-U1	P14A-U8	P14B-U4	P22-U2
12	P4-U2	P14A-U9	P14B-U5	P22-U3
13	P4-U3	P14A-U10	P14B-U6	P22-U4
14	P4-U4	P14A-U11	P14B-U7	P22-U5
15	P4-U5	P14A-U12	P14B-U8	P22-U6
16	P12-U1	P14A-U13	P14C-U1	P23-U1
17	P12-U2	P14A-U14	P14C-U2	P23-U2
18	P12-U3	P14A-U15	P14C-U3	P23-U3
19	P12-U4	P14A-U16	P14C-U4	P23-U4
20	P12-U5	P14A-U17	P19-U1	P23-U5
21	P12-U6	P14A-U18	P19-U2	P23-U6
22	P12-U7	P14A-U19	P19-U3	P23-U7
23		P14A-U20	P19-U4	P24-U1
24		P14A-U21	P19-U5	P24-U2
25			P20-U1	P24-U3
26			P19/20-U1	
TOTAL	20.5	24	25	24

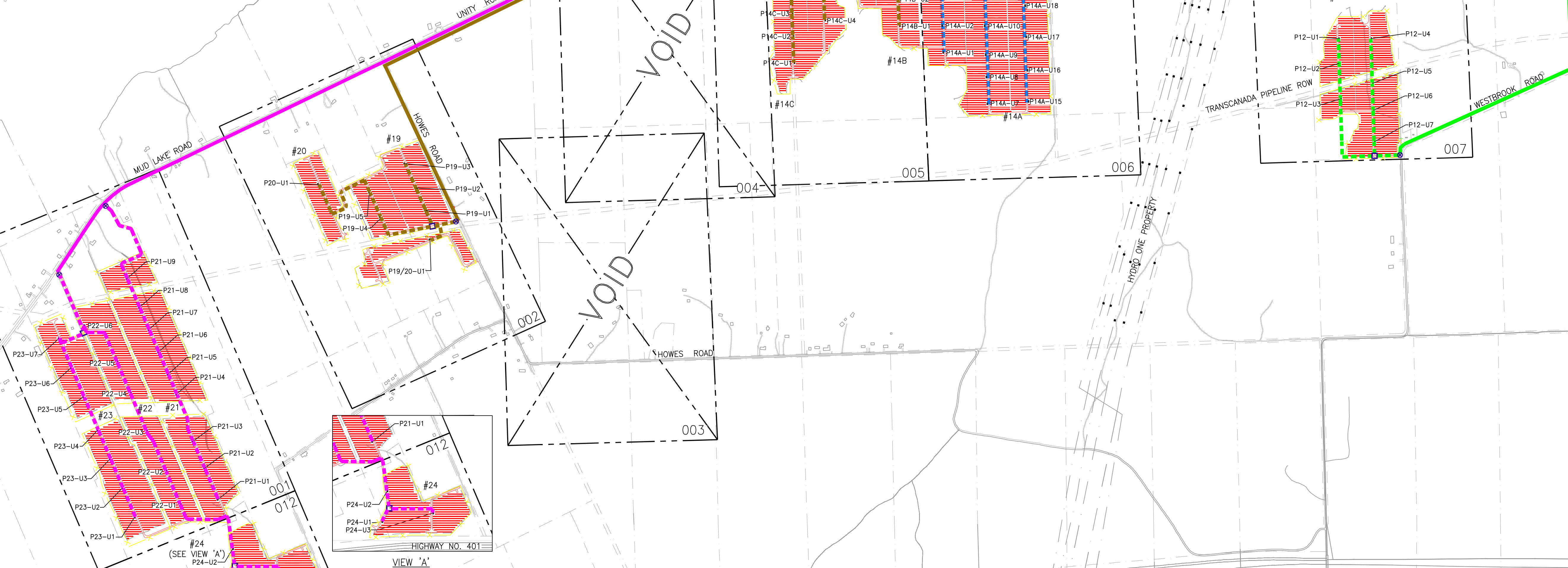

NOTES

1. FOR DETAILS REFER TO DRAWINGS LYD-0002-001 TO LYD-0002-011.

- LEGEND**
- 1MW/0.5MW INVERTER STATION
 - SOLAR PANEL TABLE (5x4 PANELS)
 - DEVELOPMENT BOUNDARY
 - ACCESS ROAD
 - PROPERTY LINE
 - UNDERGROUND COLLECTOR SYSTEM (CIRCUIT 1)
 - OVERHEAD COLLECTOR SYSTEM JOINT USE WITH HONI (CIRCUIT 1)
 - UNDERGROUND COLLECTOR SYSTEM (CIRCUIT 2)
 - OVERHEAD COLLECTOR SYSTEM JOINT USE WITH HONI (CIRCUIT 2)
 - UNDERGROUND COLLECTOR SYSTEM (CIRCUIT 3)
 - OVERHEAD COLLECTOR SYSTEM JOINT USE WITH HONI (CIRCUIT 3)
 - UNDERGROUND COLLECTOR SYSTEM (CIRCUIT 4)
 - OVERHEAD COLLECTOR SYSTEM JOINT USE WITH HONI (CIRCUIT 4)
 - 1 MW ZONE
 - PCC POINT OF COMMON COUPLING
 - PXX-ZX P: PROPERTY Z: ZONE
 - PXX-UX P: PROPERTY U: INVERTER UNIT
 - DISCONNECT SWITCH AND LIGHTNING ARRESTORS
 - CABLE TERMINATION AND LIGHTNING ARRESTORS
 - OVERHEAD COLLECTOR SYSTEM CONNECTION POINT
 - 34.5KV JUNCTION BOX

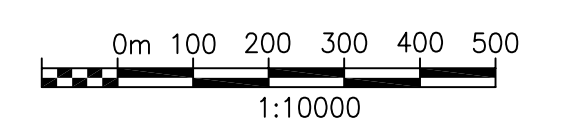

PRELIMINARY

REV	DDMMYY	REVISION / ISSUE DESCRIPTION	DRN	CHK	APP	APP	APP	APP	APP	APP
2	25APR12	ISSUED FOR CLIENT REVIEW	RS	IB	DJ					
1	14FEB12	RE-ISSUED FOR USE	RS	IB	SC					
0	15DEC11	ISSUED FOR USE	RS	IB	MP	SC				
B	08DEC11	ISSUED FOR CLIENT REVIEW	RS	IB	MP	SC				
A	05DEC11	ISSUED FOR SQUAD CHECK	RS	IB	MP	SC				

PROPRIETARY INFORMATION:
THIS DRAWING IS THE PROPERTY OF AMEC AMERICAS, LTD. AND IS NOT TO BE LOANED OR REPRODUCED IN ANY WAY WITHOUT THE PERMISSION OF AMEC AMERICAS, LTD.

STAMP/SEAL

**CONCEPTUAL DRAWING ONLY
NOT TO BE USED FOR CONSTRUCTION**

CLIENT PROJECT MGR.	DEPARTMENT MGR.	PROJECT MGR.
PROJECT PHASE	PRELIMINARY	AREA
PROJECT NO.	168335	SUBJECT
SCALE	1:10000	SOL-LUCE KINGSTON ENERGY PROJECT SITE PLAN & COLLECTOR LINE LAYOUT
PACKAGE CODE	CHK MP NOV'11 APP SC NOV'11	CLIENT DWG. NO.
		DRAWING NO.
		168335-0002-141-LYD-0001-001
		REV.
		2

amec

USER: SHARBAZIAN, RAZMIK

SAVED: 25-Apr-12 1:06 PM

PLOTTED: 25-Apr-12 1:07 PM